

SCHUYLER HEIM CONNECTION

Port of LB Call for Projects

Anaheim street and new bike facilities in Wilmington

Schuyler Heim Bridge

Bixby Path connecting to Long Beach

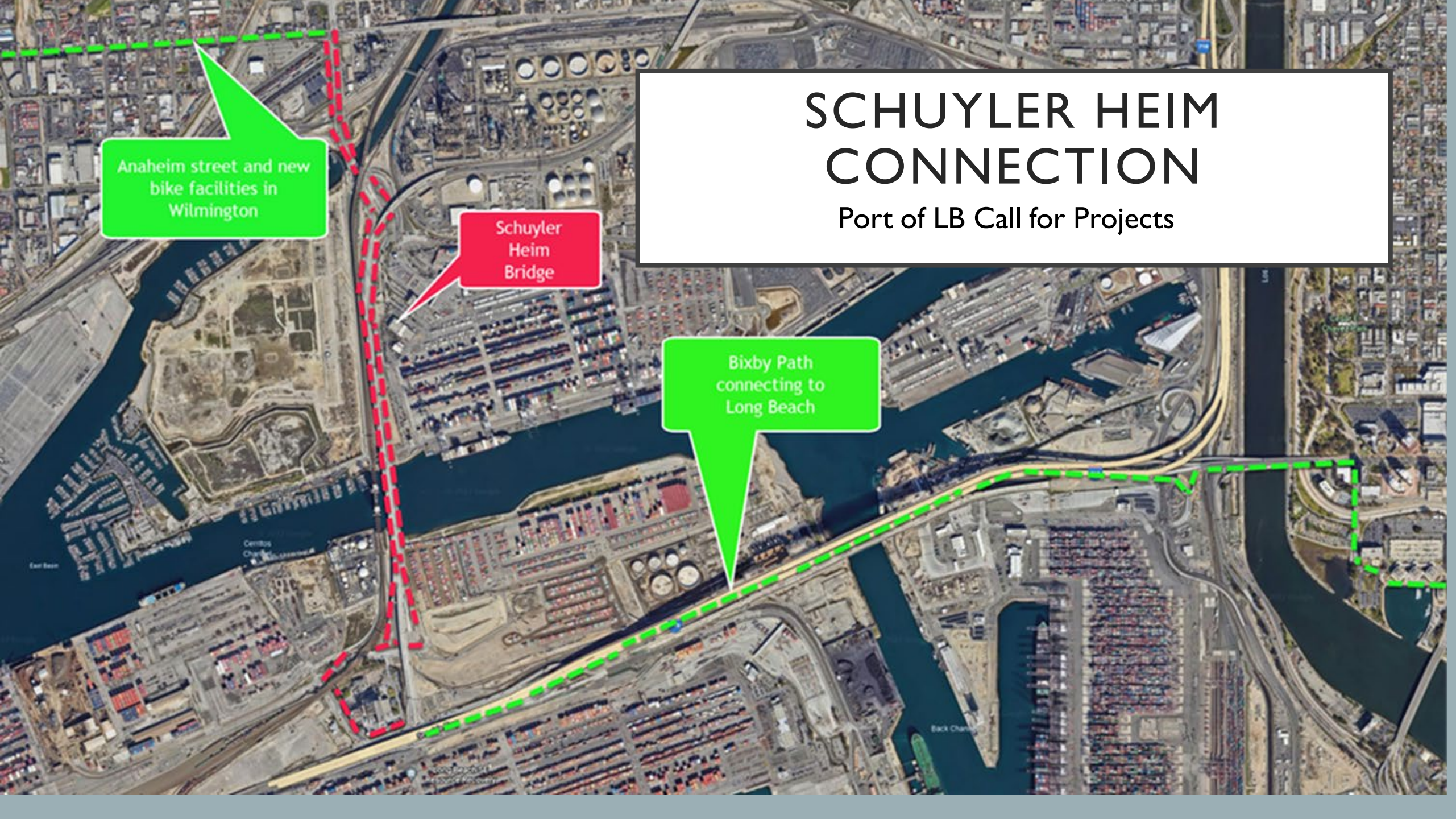

PORT FUNDS BICYCLE, PEDESTRIAN INFRASTRUCTURE PROJECTS

November 14, 2022

COMMUNITY GRANTS PROGRAM CONCEPT PAPERS DUE IN JANUARY

The Port of Long Beach is accepting concept papers for bicycling and pedestrian infrastructure projects that qualify for funding under its award-winning Community Grants Program.

The award-winning Community Grants Program is a more than \$46 million effort to fund projects that help those in the community who are most vulnerable to port-related environmental impacts. These projects are [expanding asthma services](#), [controlling stormwater runoff through the building of permeable parking lots](#), and [creating open space buffers](#) between port operator and residential areas. Combined with a previous program, making it the largest voluntary

Program. Projects that improve bicycling and pedestrian infrastructure will be considered eligible to apply. To view the program solicitation workshop, go to [www.polb.com/grantopportunities](#).



People ride bikes along Shoreline Village on December 28, 2010.

Port of Long Beach Community Grants Program \$46 mm Port Mitigation Funds

Projects that improve bicycling and pedestrian infrastructure, and street projects reducing the negative effects of vehicular traffic will be considered for grant funding. Nonprofit, 501(c)(3) organizations and government agencies are eligible to apply. To view the program's relevant Community Infrastructure guidelines and the recording of the pre-solicitation workshop, go to www.polb.com/grantopportunities.

A total of \$3 million in funding is available for the solicitation. Prospective applicants are required to describe proposed projects at a high level and program staff will determine project and applicant eligibility. Concept papers, which must be submitted online, are due by 4 p.m. Monday, Jan. 9, 2023. A conference call to answer questions about the solicitation will be held from 4-5 p.m. on Wednesday, Dec. 7 and [can be joined by clicking here](#) or calling (323) 451-1087 and entering conference identification 619 543 202#.

2 Eligibility Information

2.1 Eligible Projects

As identified in the Guidelines (Attachment A), eligible projects must achieve the two objectives listed below.

Project Objectives:

- Increase the use of alternative modes of transportation (i.e., bicycling and walking)
- Improve connectivity of existing mobility network for maximum utilization of bicycling and pedestrian infrastructure

The following projects are eligible:

- **Bicycling Infrastructure Improvements:** Projects that provide access and mobility for local and regional bicycle travel, gap closures that connect bikeway networks, on-street improvements to bicycle transit lanes and parking. This may include new or expanded bike lanes, bicycle parking, support facilities, and traffic-calming measures as described below.

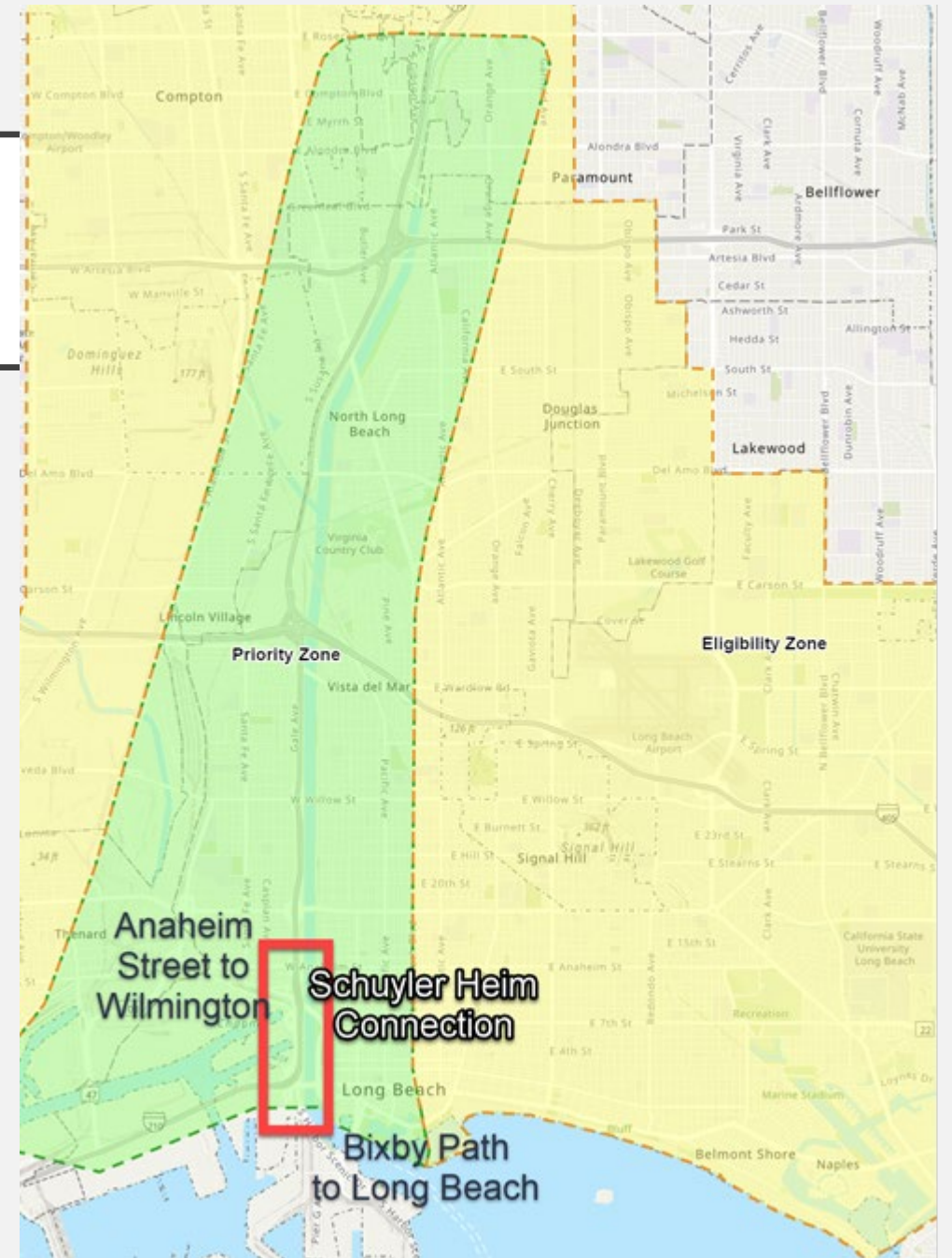

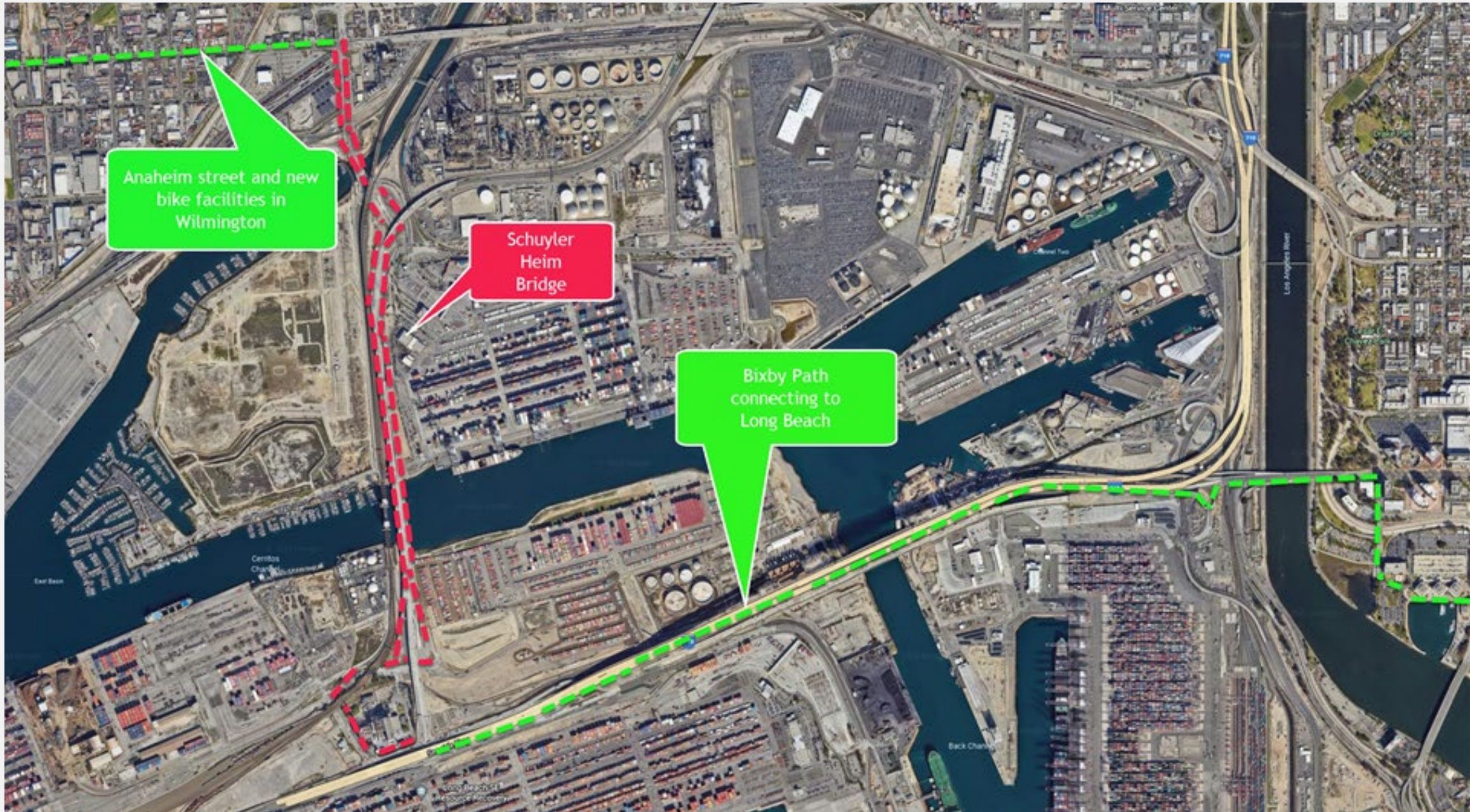

Anaheim street and new bike facilities in Wilmington

Schuyler Heim Bridge

Bixby Path connecting to Long Beach



BIXBY BIKE & PED PATH



ANAHEIM STREET WILMINGTON

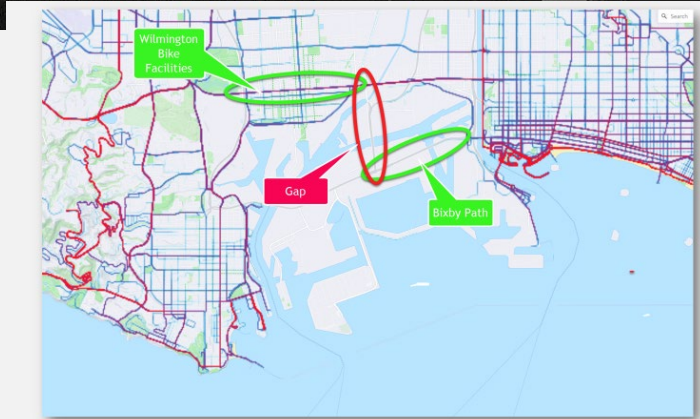

BIKE USAGE STRAVA HEAT MAP

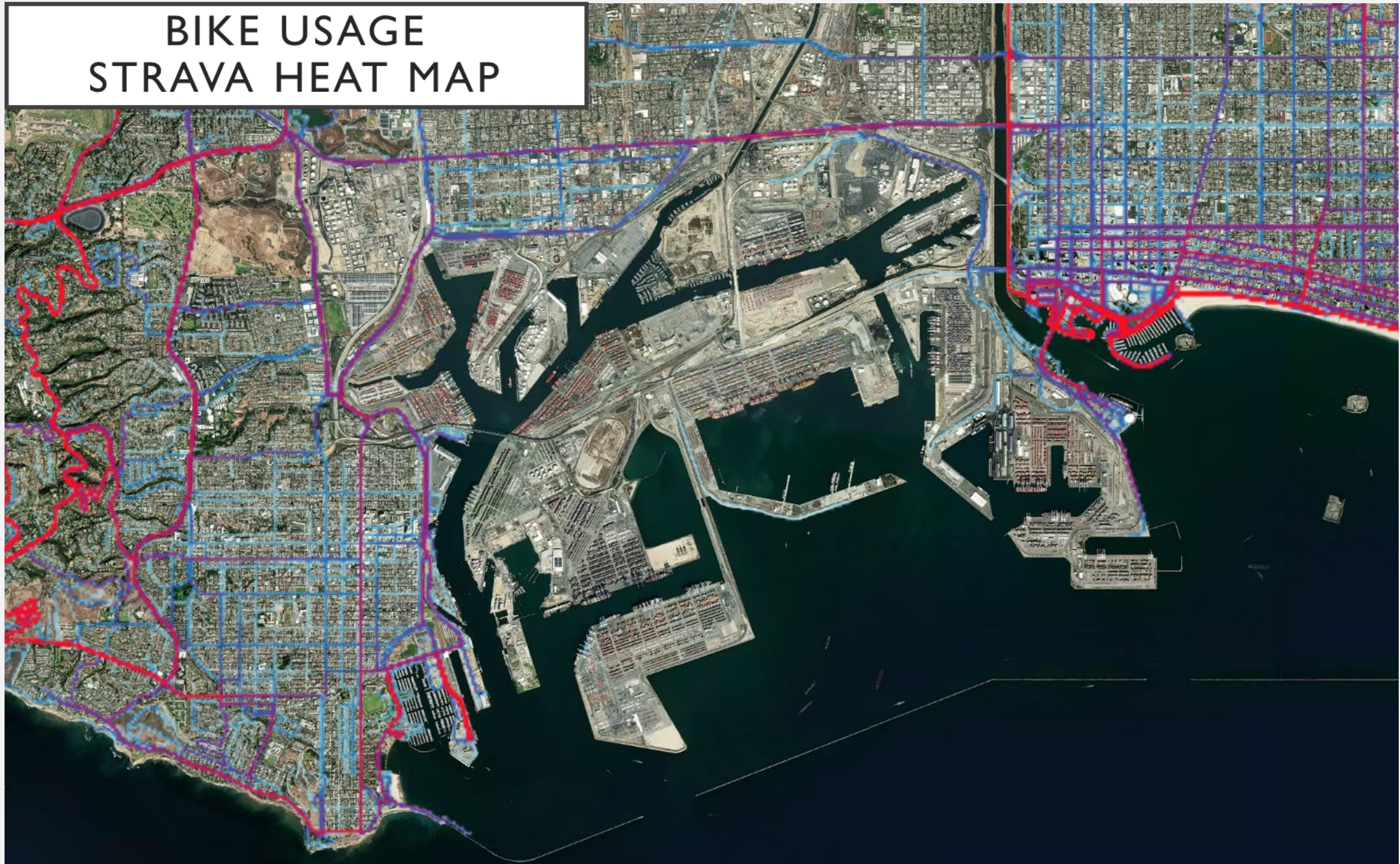

Wilmington
Bike
Facilities

Gap

Bixby Path

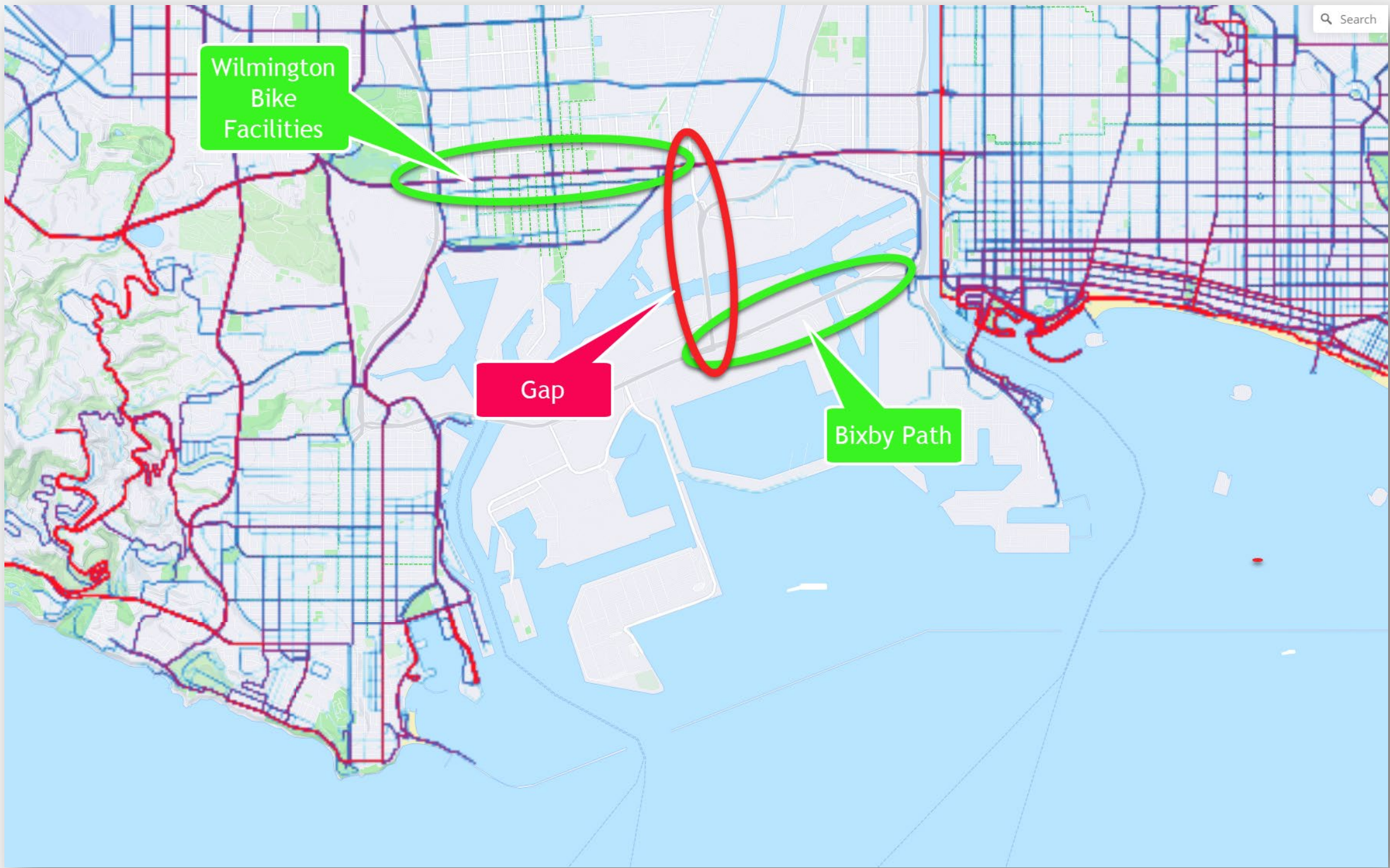

PACIFIC COAST BIKE ROUTE

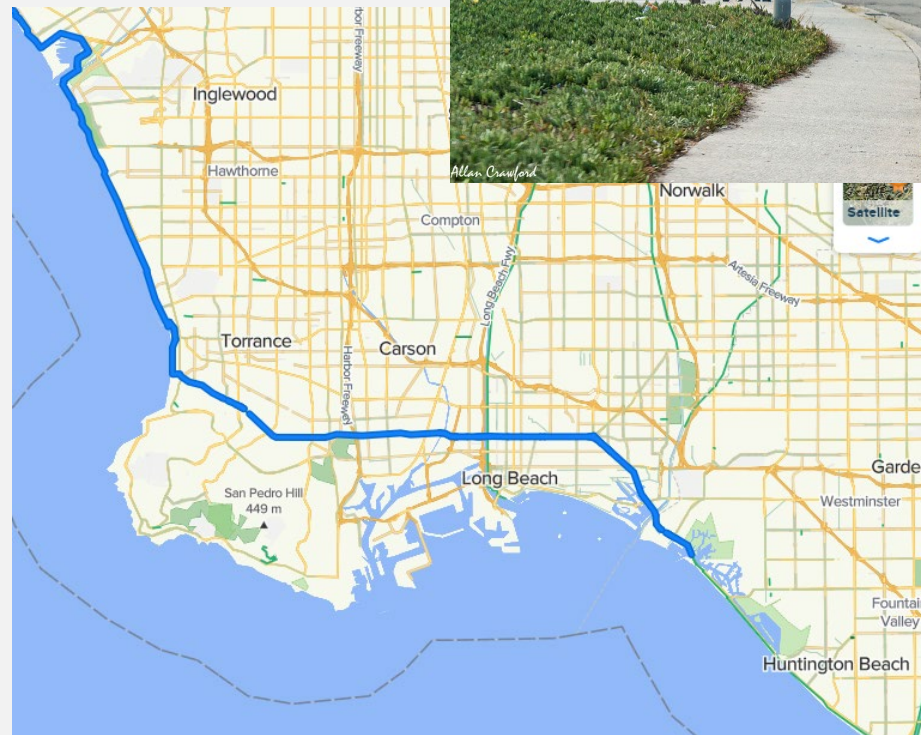
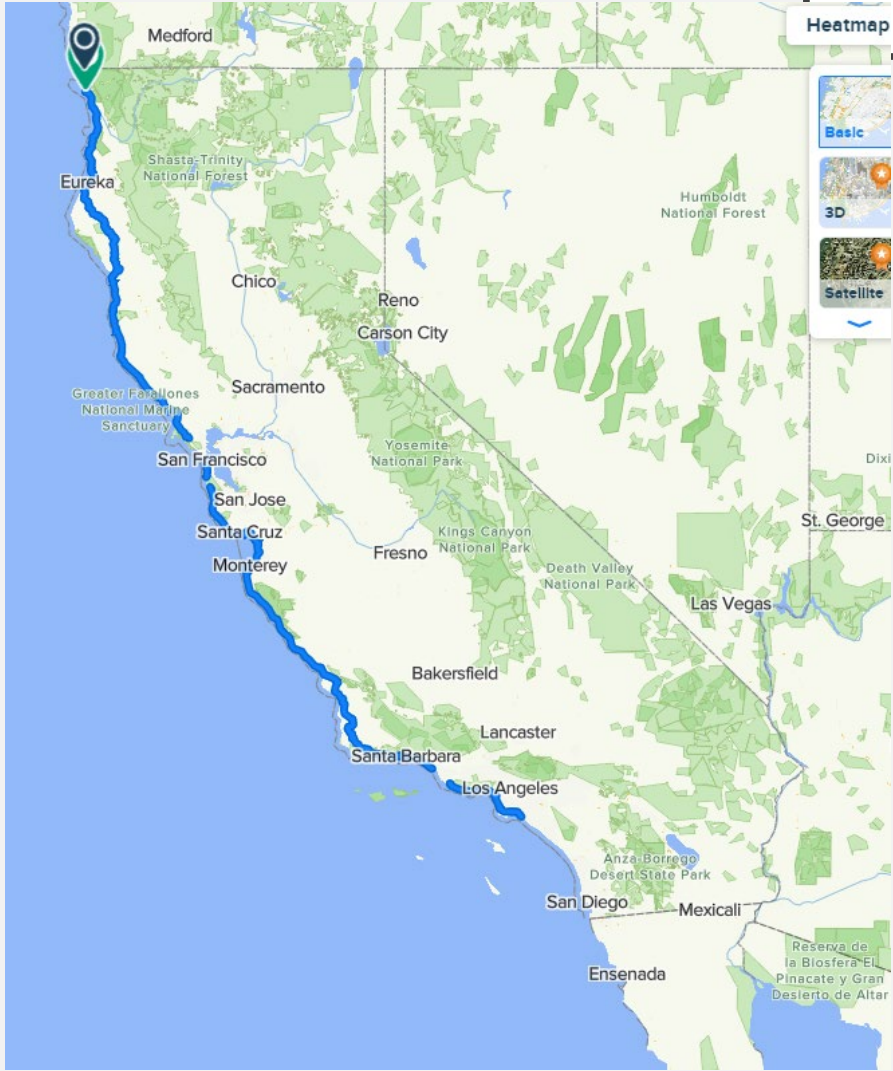

Southern end of project area
Looking north to

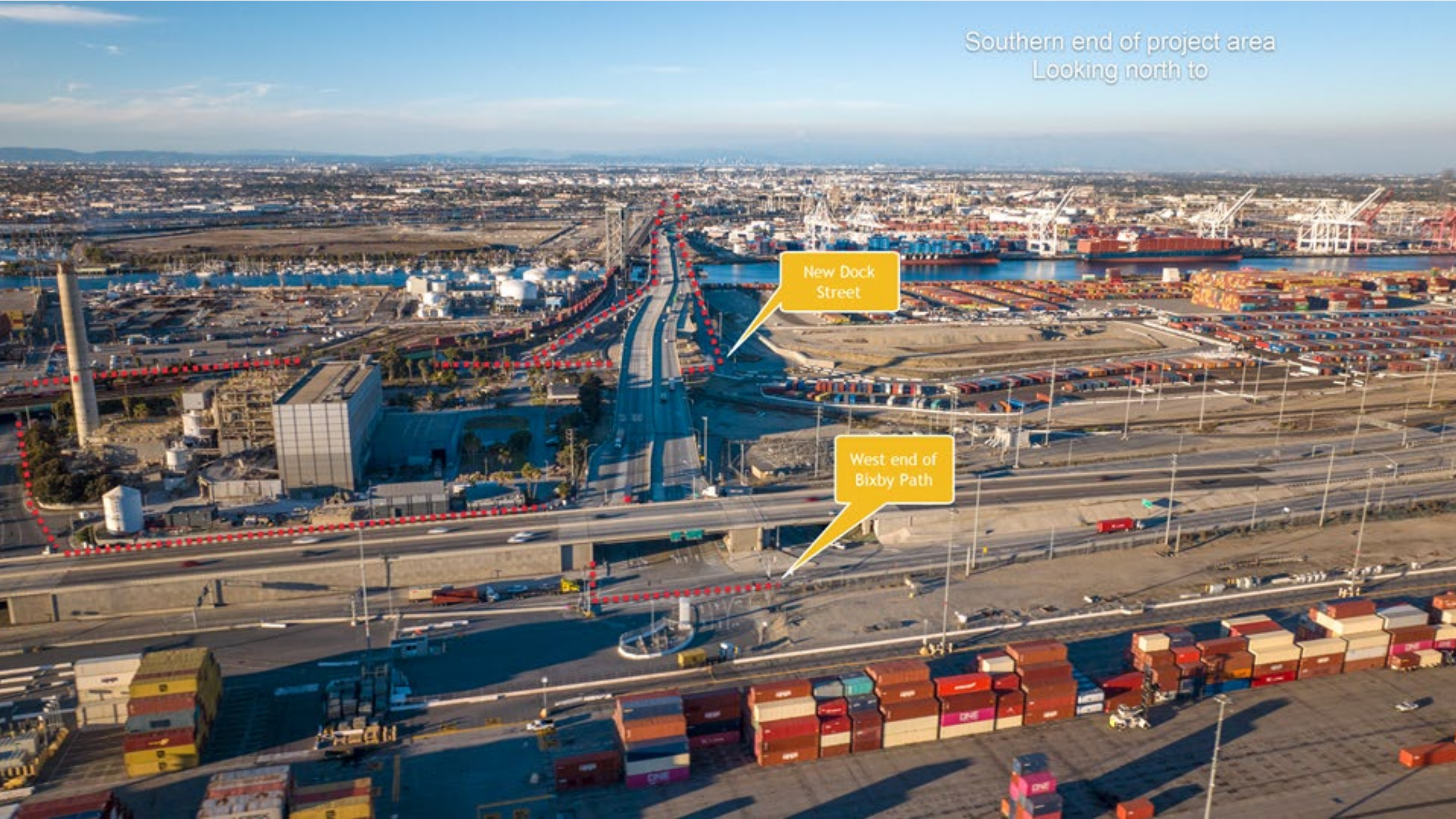

New Dock Street

West end of Bixby Path

PHOTOS
SHOWING AS IS
CONDITIONS

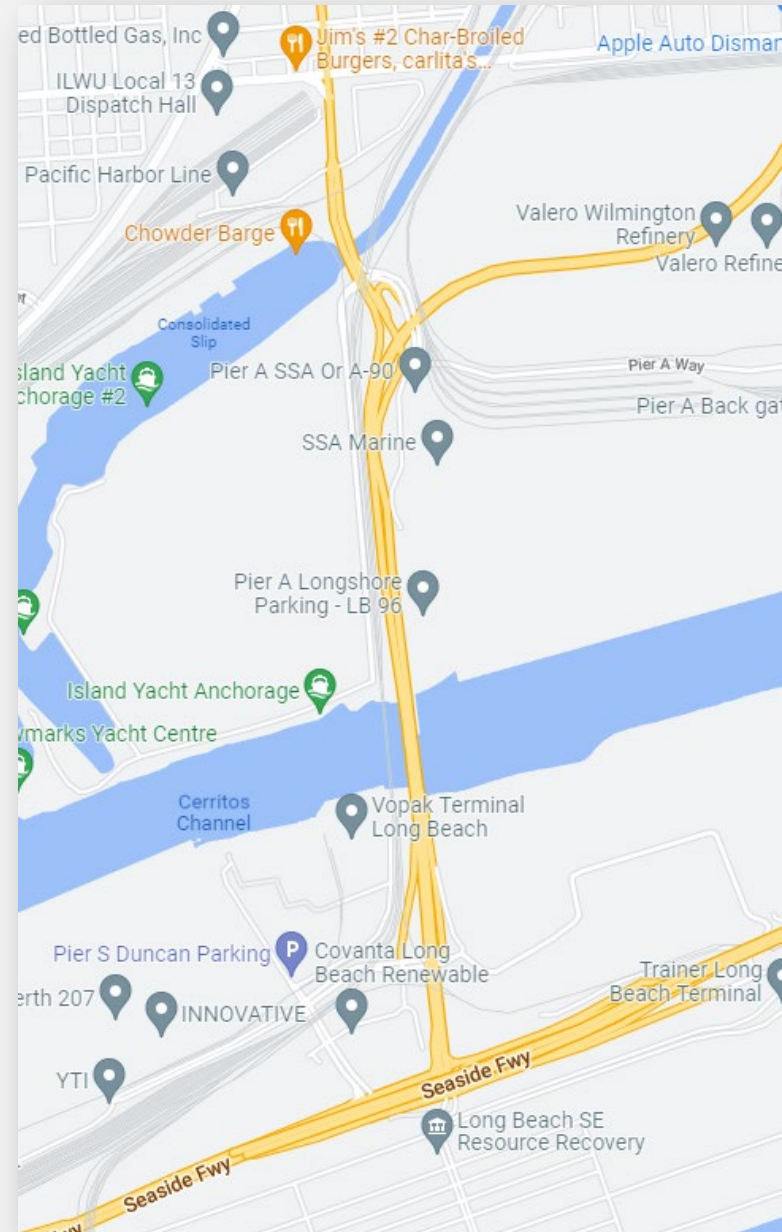

WEST END OF BIXBY PATH

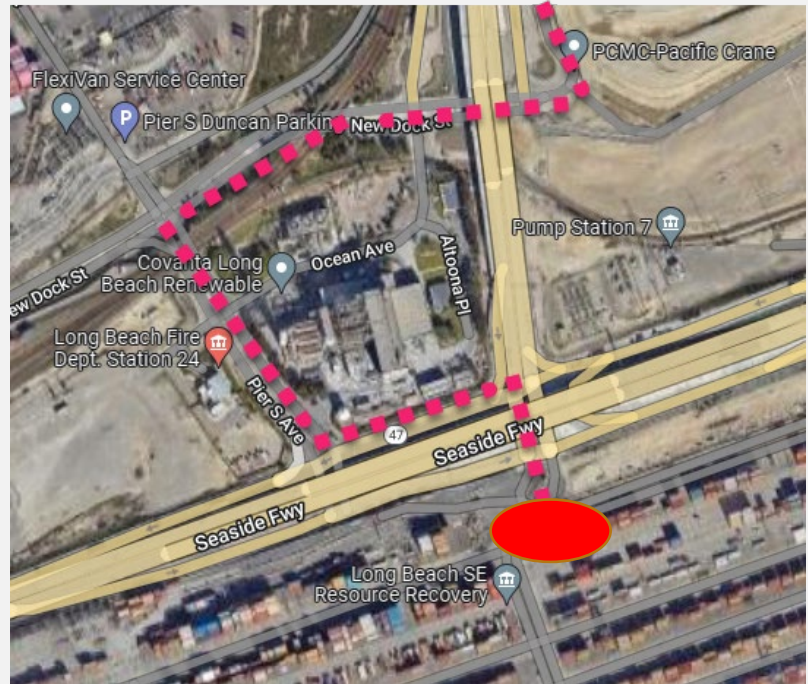
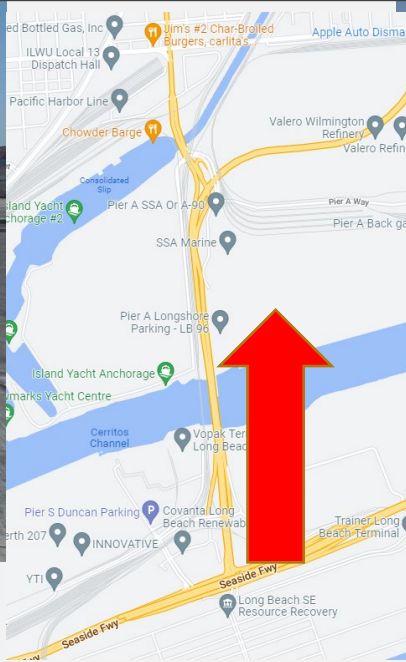

ACCESS ROAD SERRF PLANT

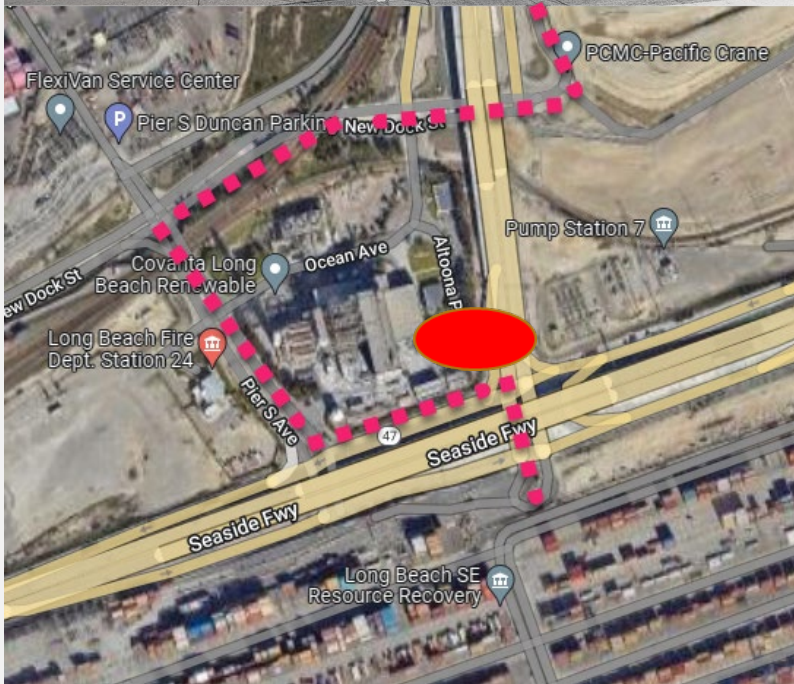

WEST SIDE OF SERRF PLANT

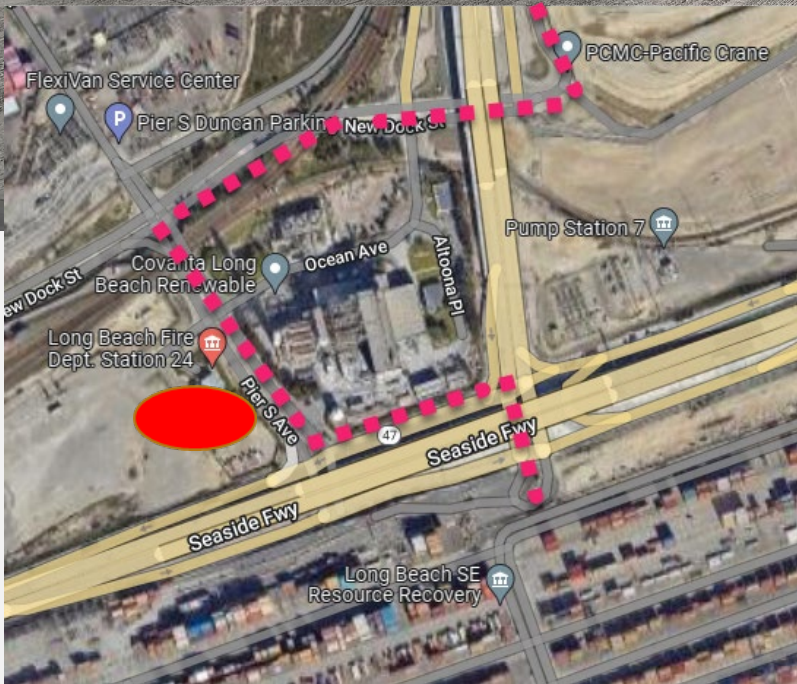

NEW DOCK STREET

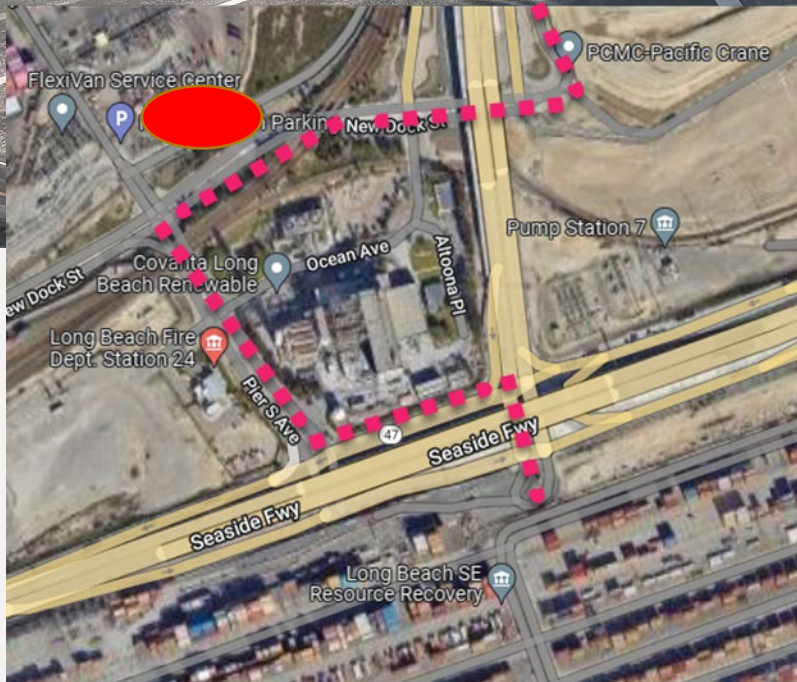
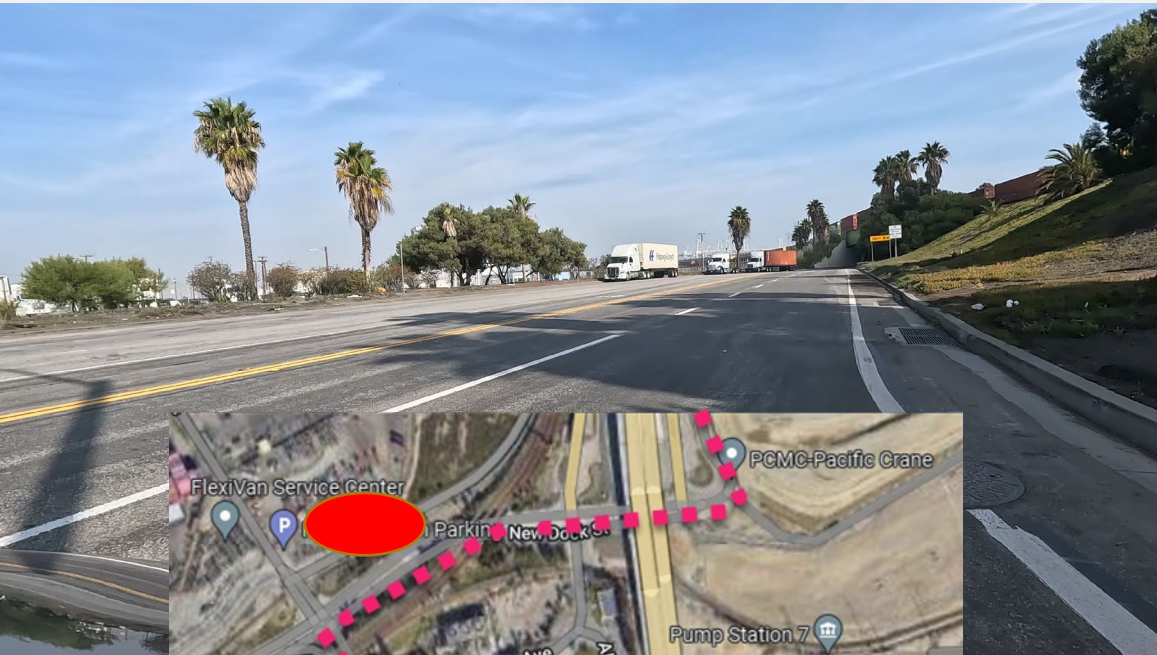

SCHUYLER HIEM FROM NEW DOCK

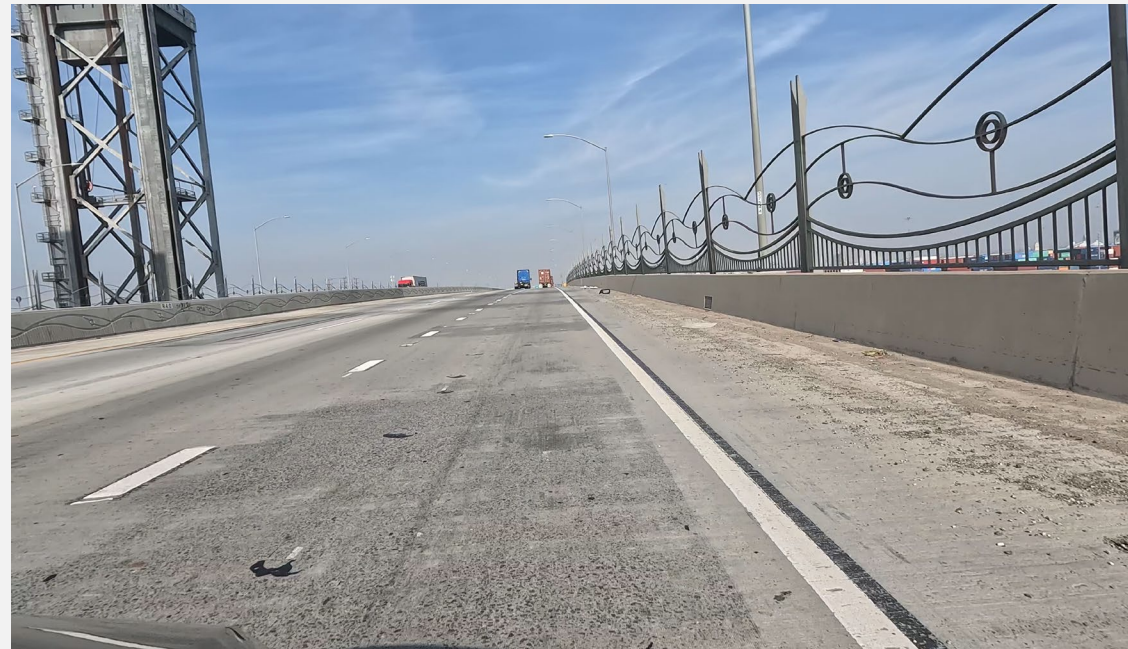

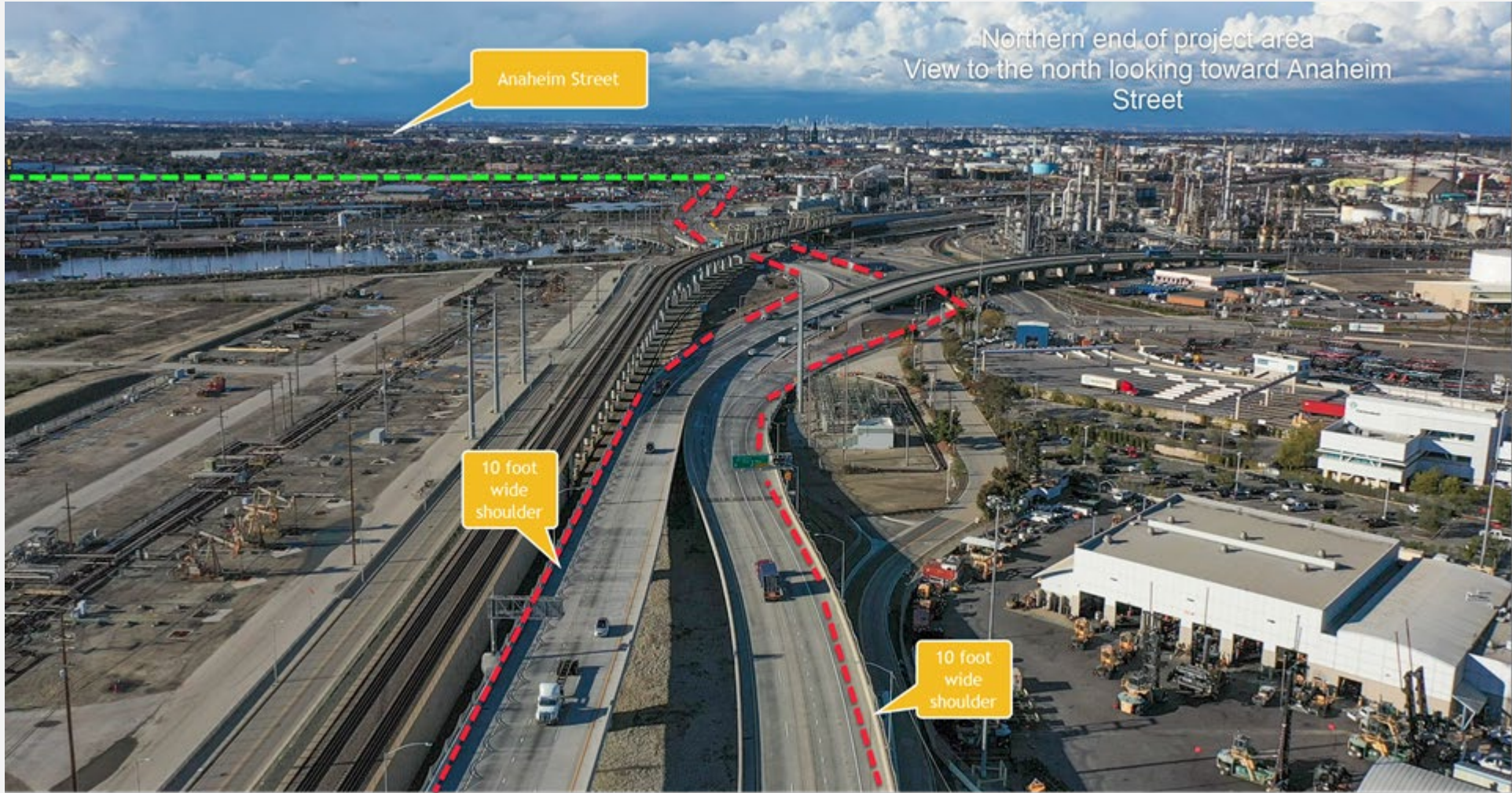

Northern end of project area
View to the north looking toward Anaheim
Street

Anaheim Street

10 foot
wide
shoulder

10 foot
wide
shoulder

EXIT TO 47 / HENRY FORD

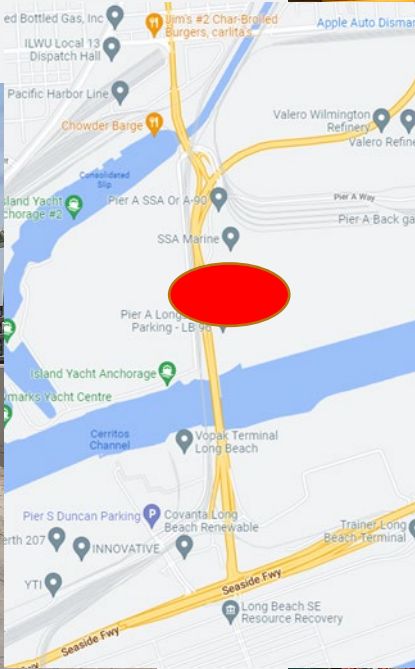

SCHUYLER HEIM TO HENRY FORD

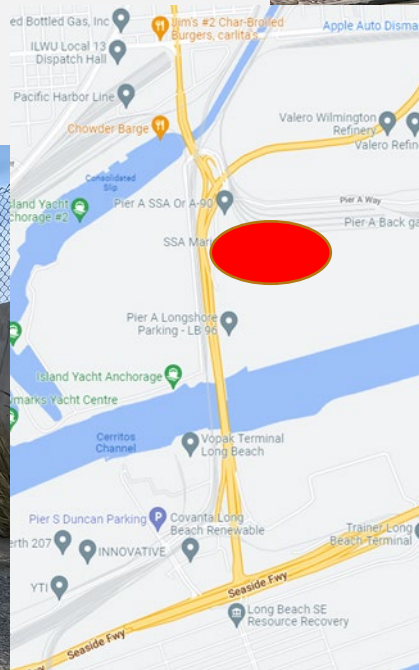

NORTH BOUND HENRY FORD

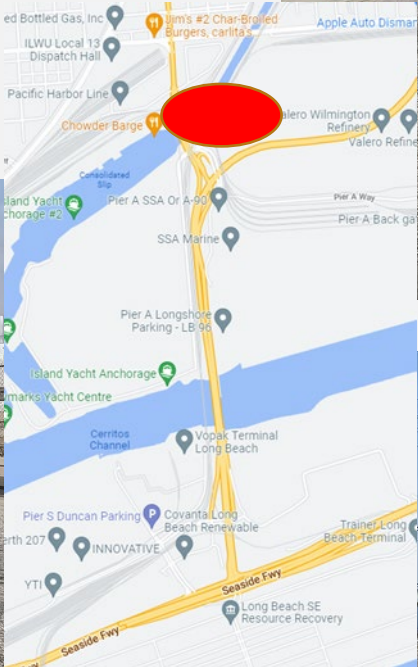

SOUTH BOUND SCHUYLER HEIM

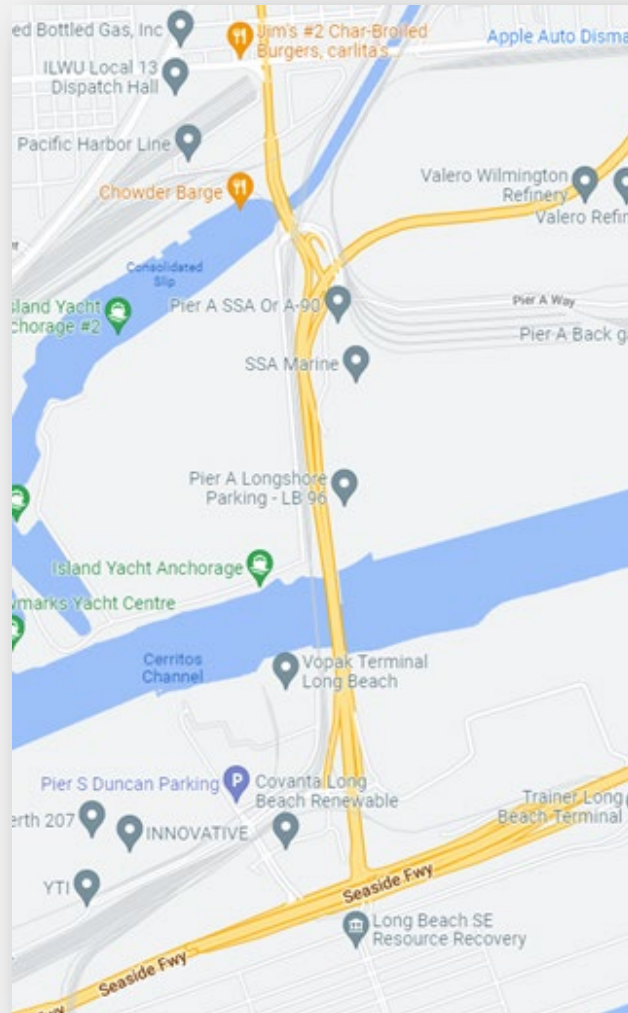

SOUTH BOUND HENRY FORD

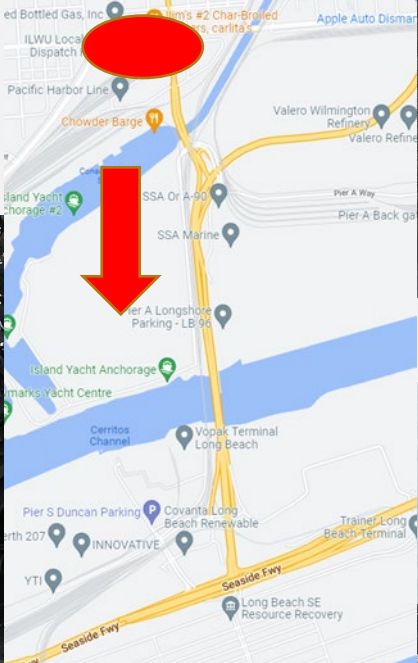
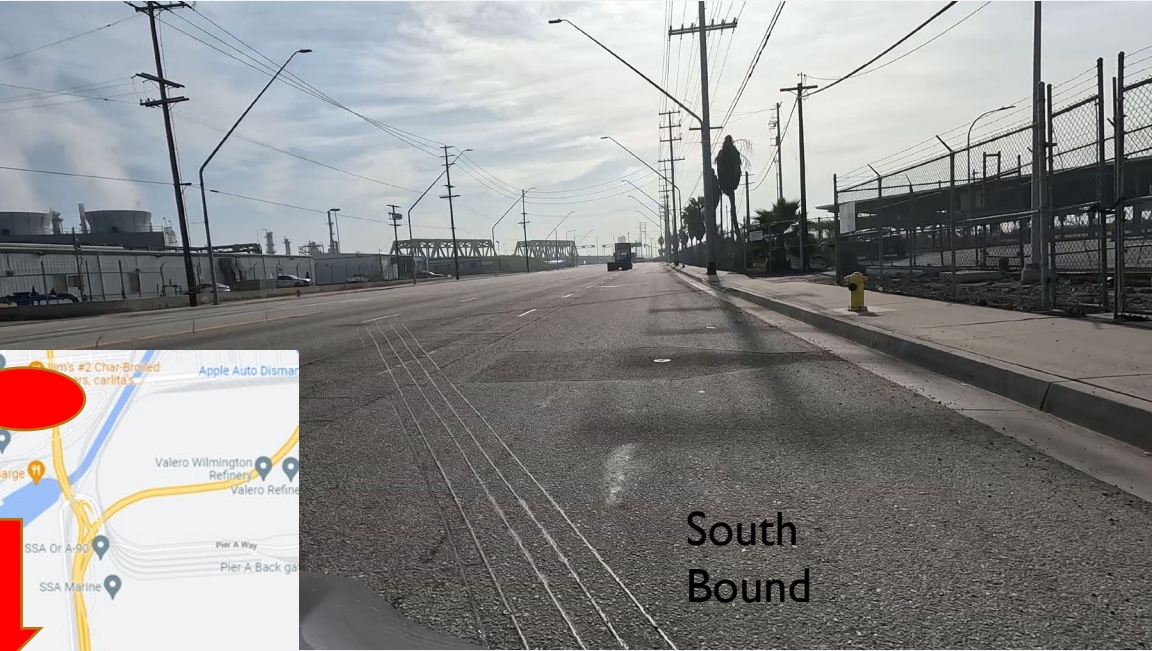

SOUTH BOUND ONTO SCHUYLER HEIM

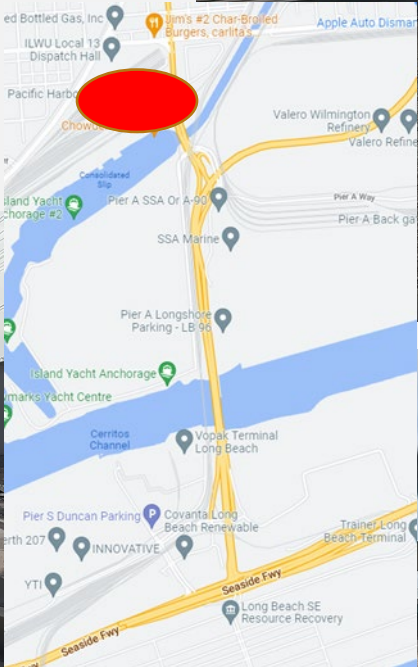

SOUTH BOUND SCHUYLER HEIM

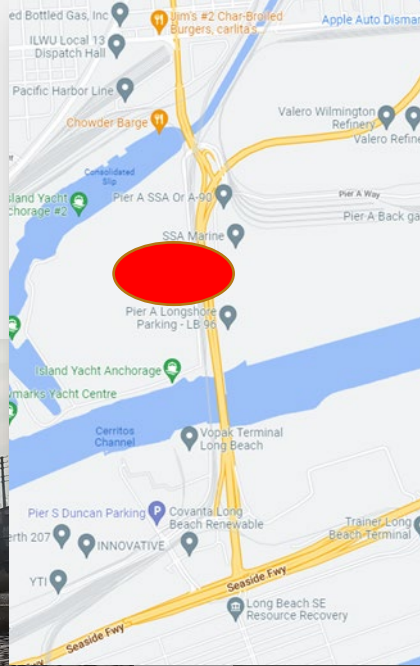

NEW DOCK EXIT

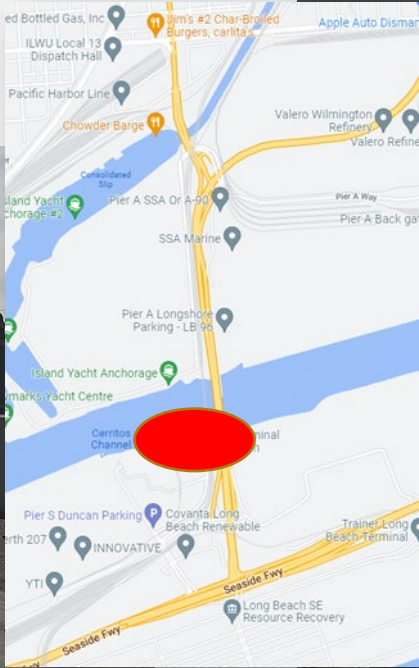

NEW DOCK & PIER S

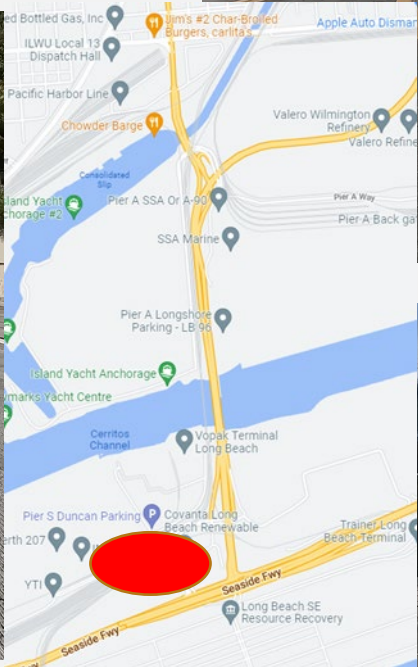

THE SCHEDULE

Table 1. Bicycling and Pedestrian Infrastructure Key Dates

Activity	Anticipated Date*
Concept Paper Released	November 14, 2022
Q&A Conference Call	December 7, 2022
Q&A Documents Posted to Grants Web Page	December 15, 2022
Concept Paper Due	January 9, 2023
Applicants Notified of Invitation to Submit Full Proposal	January 23, 2023
Full RFP Released	February 13, 2023
Post-Solicitation Webinar	March 1, 2023
Deadline to Submit Full Proposal	April 10, 2023
Notice of Proposed Award	May 2023
Board of Harbor Commissioners Approve Awards	June 2023
Contracting Completed	July 2023
Project Period Begins	Late July 2023

**These are anticipated dates and are subject to change.*

4 p.m.

Funding Amount Available	\$3 million No minimum funding request <i>*The Port does plan to award multiple projects</i>
Project Duration	Up to 4 years
Grant Period Start and End Dates	4 years after contract execution
Deadline to Enter into Contract	6 months after award approval by the Board of Harbor Commissioners
Project Types	Bicycling and Pedestrian Infrastructure projects pursuant to the Community Infrastructure Guidelines , Appendix B

Application Submittals Checklist

Required Documentation for Submittal

- Project Narrative

Additional Requirements

- Bikeways must conform to Chapter 1000 of the Caltrans Highway Design Manual
- Project must identify any and all local, state, and federal permit requirements, including the Americans with Disabilities Act.
- Applicable project elements must comply with the most current "Greenbook" Standard Specifications for Public Works Construction.
- If the organization is not the land/facility owner, a signed letter from the land/facility owner expressly agreeing to the project must be submitted. If a signed letter cannot be provided before the concept paper solicitation closes, one must be submitted prior to submission of a full proposal within the second step of this solicitation process (described in Section 5 on page 10 of this RFP).
- Project applicants requesting up to one year of funding for median trees maintenance must provide funding plans within the second step of this solicitation process.

Supporting Documents

Attach the following Supporting Documents to the end of your full proposal narrative. The Supporting Documents below are **not** included in the 1 page limit for the narrative:

Optional Documents

- A copy of the current plans, specifications, concept engineer's drawings, or other illustrative figures.

The following projects are **not** eligible for funding:

- Bicycling or walking facilities that do not demonstrate the potential to reduce vehicle trips, i.e., those primarily used for recreational purposes
- Bicycle or pedestrian facilities that duplicate existing facilities
- Repair or replacement of existing infrastructure or facilities
- Stand-alone plans, environmental or design project phases not resulting in actual construction

Projects must be completed and all funds disbursed within four years after execution of a contract with the Port of Long Beach.

In addition, eligible applicants **must** demonstrate how the bicycling and pedestrian infrastructure will be maintained and sustained beyond the life of the project. This includes identifying resources needed to provide basic support facilities.

WHAT WE NEED FROM CALTRANS

Anaheim street and new bike facilities in Wilmington

Schuyler Heim Bridge

Bixby Path connecting to Long Beach

